

DIN PN 16 - 40 — DN 15 to 25 mm
 ANSI 125 - 300 — 1/2" to 1"

TA 11, 12, 33, 35

Application

For drainage of compressed air lines or of other gases. They are also applied, for deaeration of pipes and vessels containing liquids.

Description

The float traps of the TA series are automatic drainage valves with guided ball shutter. Through this system, a high discharge of condensate is achieved by the trap. Opening and closure are accomplished by the float through the condensate level.

Mean features

- Guided ball shutter minimizes wear per attrition.
- Removable cover allows easy access to the regulator set, without need of disassembling the body of the line.
- Minimum maintenance.
- High versatility of connections.

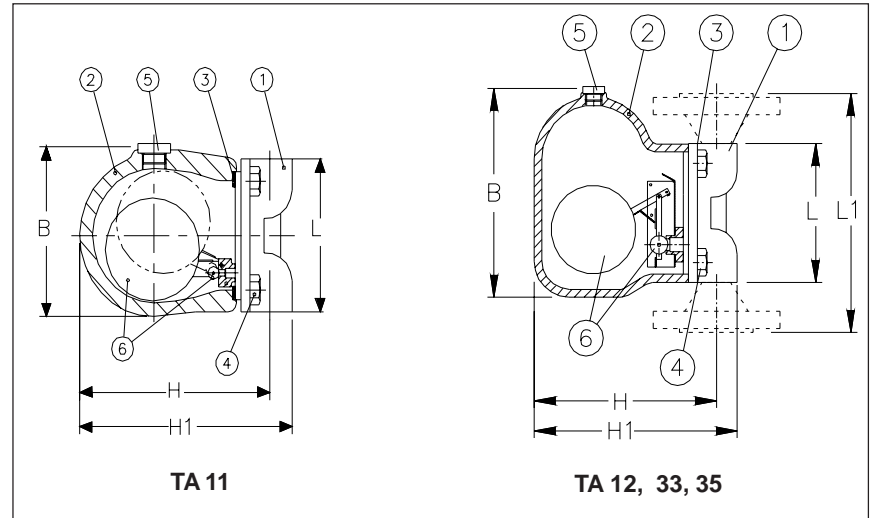

Presentation

The traps are with screwed body and cover. The model TA 11 is given threaded but the models TA 12, TA 33 and TA 35 can be given threaded or flanged.

Optionals

- Lever for hand driving of the float.
- Drain valve.

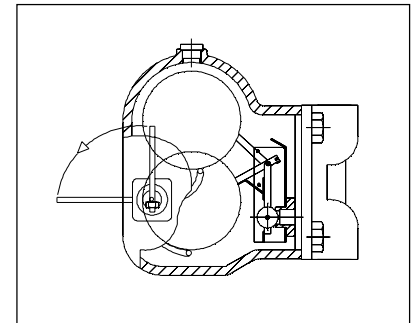

Technical competence, materials and conexões

Model		TA 11	TA 12	TA 33	TA 35		
Nominal Diameter	(mm) (pol)	15 20 1/2" 3/4"	15 1/2"	20 3/4"	25 1"		
Maximum operating pressure	(bar man)	16	13	40 32 21	40 33 29		
Max. correspondent temperature	(°C)	120	300	120 250 400	120 250 400		
Materials	Nº	Description	Quant.	Specification			
	1	Body	1	Cast iron ASTM A 126 B	Cast carbon steel ASTM A 216 WCB**	Cast carbon steel ASTM A 216 WCB	Cast stainless steel ASTM A 351 CF8M
	2	Cover	1	Cast iron ASTM A 126 B	Cast iron ASTM A 536	Cast carbon steel ASTM A 216 WCB	Cast stainless steel ASTM A 351 CF8M
	3*	Gasket	1	Hidraulic cardboard			
	4	Screw	4	Qual. 8.8			
	5	Plug	1	Stainless steel			
	6	Regulator assembly	1	Stainless steel			
	6.1*	Float with lever	1	AISI 304			
6.2*	Seat (no gasket in TA 11)	1	AISI 420				
6.3	Ball with pin and bushing	1	Buna-N				
Connections	Thread	BSPT or NPT					
	Flanged	DIN PN 10/16 or 25/40 ANSI B 16.5 Class 150 ojr 300					
	Weld	ANSI B 16.11					

* Recommended spare parts

**Body in nodular soft iron ASTM A 395, when threaded.

Measures and weights

Model	TA 11	TA 12/33	TA 35
Measures (mm)			
L	—		120
L ₁	98		200
H	130		168
H ₁	148		192
B	116		151
Approximated weight (Kg)			
Threaded / welded	4,0	6,0	6,0
Flanged	—	7,5	8,5

Installation

Must be rigorously noticed the marking "H" or "V" that indicates the vertical or horizontal position, respectively.

So, must be noticed the flow indicator arrow and the float position that always must work in the vertical direction.

In both cases is essential the installation of a balance pipe between the main line and the cover.

Operating

The operating of the TA traps is controlled by variation of the amount of affluent condensate. While the volume of the condensate increases, the level goes up, raising the float which lever dislocates the ball shutter to the opening, during while the amount of condensate become equal, establishing a new level, that keeps constant. When the volume of affluent condensate decreases, the process inverts, and, when the minimum level is reached, the ball shutter seats in the seat, closing the trap.

Flow chart

The chart shows the maximum flows of the different exit orifices available for each model of the TA float traps. If there is elevation of the condensate after trap, don't disdain the backpressure about 1 bar for each 7 meters high of elevation.

Capacity chart

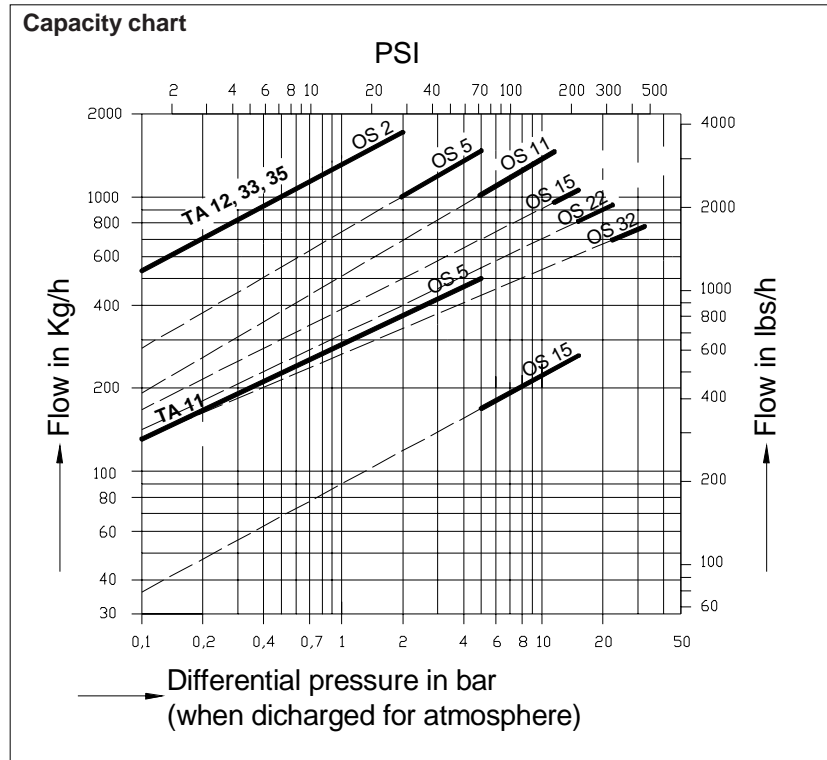

Available orifices listing

There are many exit orifices (OS) in each type of trap, that correspond to its maximum distinguishing pressure.

- OS 2 = differential pressure from 0 to 2 bar
- OS 5 = differential pressure from 2 to 5 bar
- OS 11 = differential pressure from 5 to 11 bar
- OS 15 = differential pressure from 11 to 15 bar
- OS 22 = differential pressure from 15 to 22 bar.
- OS 32 = differential pressure from 22 to 32 bar

Data for sizing

- ASCA will make with pleasure the sizing calculation.
- For this purpose must be supplied:
- Service Pressure
 - Back pressure
 - Flow of the condensate to be purged
 - Nominal diameter of the float trap
 - Desired size of the outlet orifice (OS).

Standart Specification

- Float trap for compressed air
- Model TA..... form ASCA.
- As per prospect PR-01.60.10-I.
- OS.....
- Position
- Connections.....
- as per norm
- pressure Class
- Nominal diameter
- Optional

